

Printer Hard Disk Type 5000

(Code: G315)

For Machine Code: G071

INSTALLATION GUIDE

Preparation

For safe operation, see "Safety Information", *Maintenance Guide 1*.

CAUTION:

- Do not touch the inside of the controller board compartment. It may cause a machine malfunction or burn.

Important

- Check the printer nameplate to confirm the model code.
- Earth yourself by touching a metal object before handling the printer hard disk — even small static charges can damage it.
- Do not subject the printer hard disk to impact.

1 Check the contents.

◆ Printer Hard Disk Type 5000

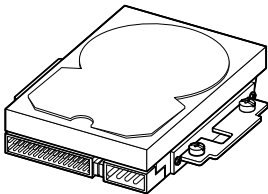

◆ Flat cable



◆ Power cable

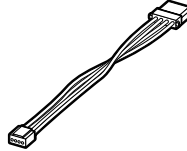

◆ Four screws

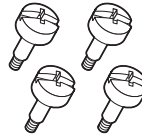

2 Turn off the power switch, and then unplug the power cable.

3 Remove the dustproof filter cover on the back of the printer. First, lift the cover (1), and then remove it (2).

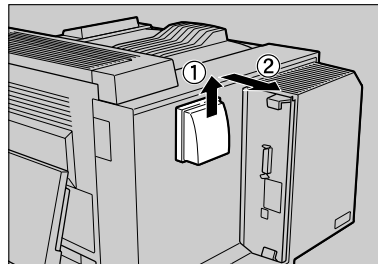

ZESH212J

- 4** Remove the other dustproof filter cartridge by lifting it up.

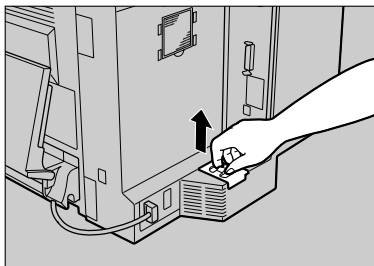

ZESH760J

Important

- Do not shake the removed cartridge. Dust may fall out.

- 5** Remove the two screws fastening the controller board onto the back of the printer.

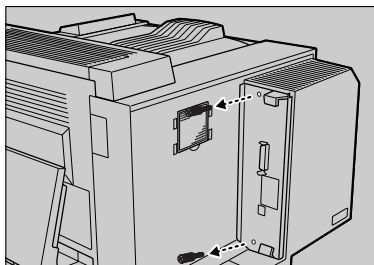

ZESH750J

The removed screws are used in step 10 to refasten the controller board.

- 6** Use the handles to pull the controller board slowly out.

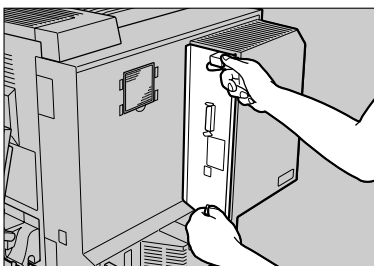

ZESH751J

Install the printer hard disk on the back of the controller board.

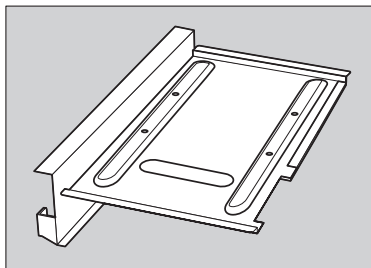

ZESP406J

- 7** Pass the flat cable (1) and power cable (2) up through the hole in the controller board.

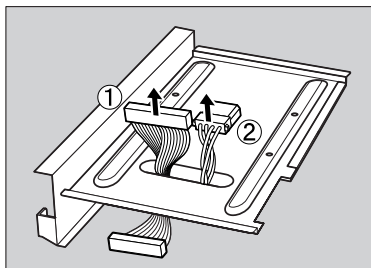

ZESP996E

- 8** Connect the flat cable (1) and power cable (2) to the printer hard disk.

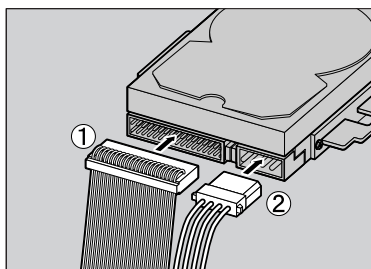

ZESP035J

Important

- The shape of the power cable's plugs differ. Insert the larger plug in the direction shown.

- 9** Fasten the printer hard disk onto the back of the controller board using the four screws.

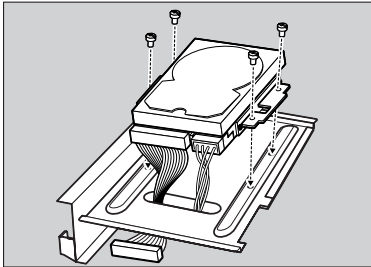

ZESP998E

Use a coin to fasten the screws tightly.

- 10** Turn the cables over, and then connect them to the controller board slots.

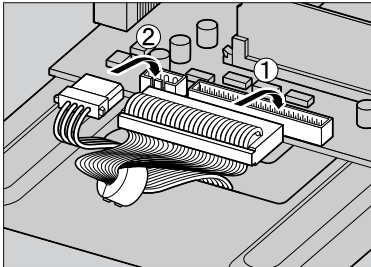

ZESP997E

- 11** Align the controller board with the top and bottom rails, and then slowly push it in until it stops.

 **Note**

- When installing another option, do not close the controller board, but proceed to the steps for installing that option.

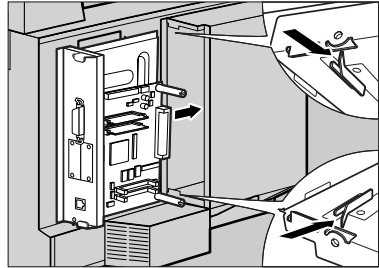

ZESP030J

 **Important**

- The printer may not work properly if the controller board is not properly configured.

- 12** Tighten the two screws removed in step **9** to fasten the controller board back into its original position.

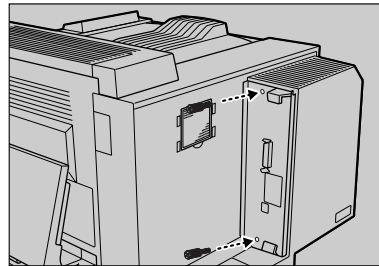

ZESH752J

Use a coin to fasten the screws securely.

- 13** Re-set the dustproof filter cartridge removed in step **4**.

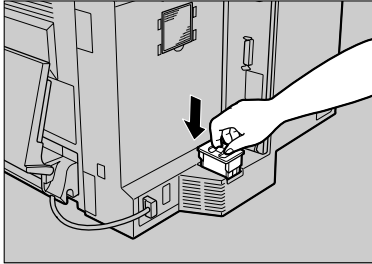

ZESH761J

Important

- Do not shake the removed cartridge. Dust may fall out.

- 14** Re-set the dustproof filter cover removed in step **8**. First, insert its protruding clips into the holes on the printer (1), and then slide it downward (2).

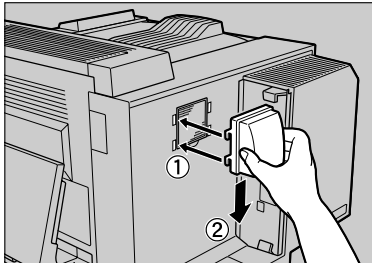

ZESH216J

When installation is complete, the printer hard disk is automatically formatted.

Note

- After finishing installation, check the printer hard disk is properly installed: Print the configuration page from the "List/Test Print" menu. If it is installed properly, "Installed" appears under "Printer Hard Disk Drive".
- If the printer hard disk is not properly installed, "Not Installed" appears. In this case, repeat the install procedure from step **1**. If you cannot install it properly even after repeating the install procedure, contact your sales or service representative.

Reference

See "Using the Control Panel", *Administrator Reference* to print the configuration page.

Important

- Before using the new printer hard disk, make the necessary settings in **[Accessories]** of the printer driver.